



16 Arden Drive

Ashford, TN24 8YD

Price £245,950

An immaculately presented terraced home just a short walk from Ashford town centre with its wide range of shopping and leisure facilities and mainline station.

The tastefully decorated home comprises an entrance hall, sitting room, kitchen/dining room, two bedrooms and bathroom/wc. Gas central heating and double glazing are installed with the property also benefitting from an enclosed rear garden and allocated parking.

NO ONWARD CHAIN

Viewing

Please contact our Ashford Office on 01233 646411 if you wish to arrange a viewing appointment for this property or require further information.

- TERRACED HOUSE
- TWO BEDROOMS
- KITCHEN/DINING ROOM
- VERY WELL PRESENTED
- ENCLOSED REAR GARDEN
- ALLOCATED PARKING
- GAS CENTRAL HEATING & DOUBLE GLAZING
- SHORT WALK FROM TOWN CENTRE & MAINLINE STATION
- NO ONWARD CHAIN



Floor Plan

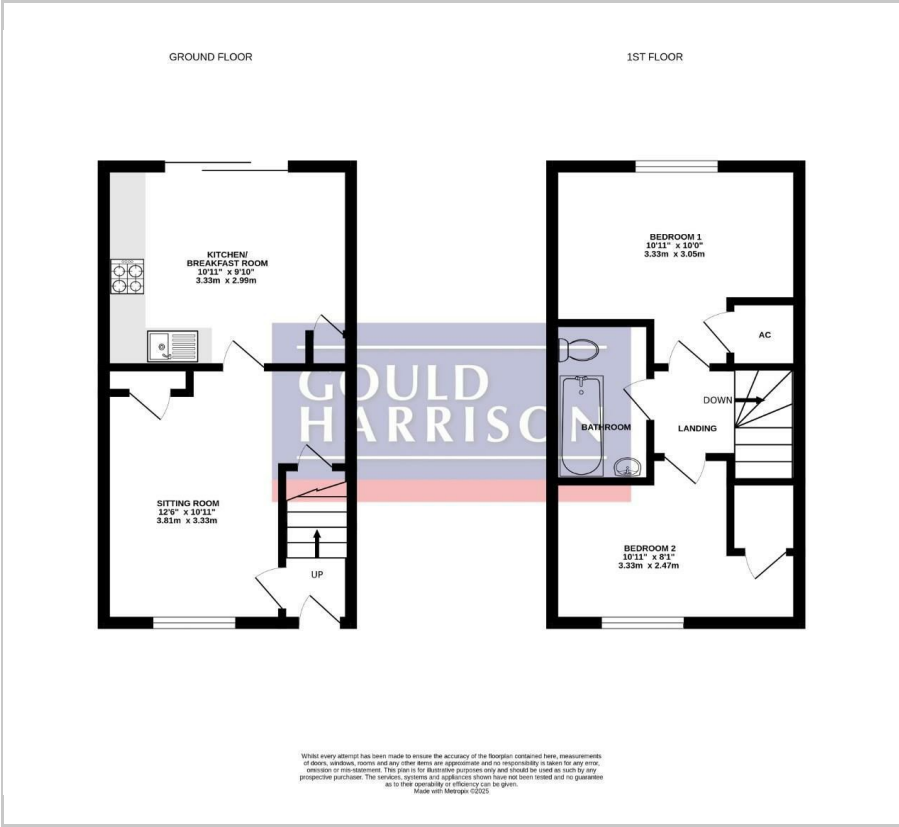

Area Map



Energy Efficiency Graph

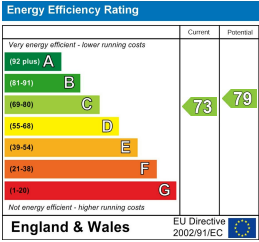

These particulars, whilst believed to be accurate are set out as a general outline only for guidance and do not constitute any part of an offer or contract. Intending purchasers should not rely on them as statements of representation of fact, but must satisfy themselves by inspection or otherwise as to their accuracy. No person in this firms employment has the authority to make or give any representation or warranty in respect of the property.